

Notice of variation and consolidation with introductory note

The Environmental Permitting (England & Wales) Regulations 2010

Karalius Brothers Waste Limited
Karalius Brothers (Waste) Limited
Dennis Road
Widnes
Cheshire
WA8 0YQ

Variation application number
EPR/DP3296CF/V003

Permit number
EPR/DP3296CF

Karalius Brothers (Waste) Limited

Permit number EPR/DP3296CF

Introductory note

This introductory note does not form a part of the permit

The main features of the permit are as follows.

This variation has been made by the operator to add two activities to their existing permit and to update the permit to modern conditions. The application is to add Waste Electrical and Electronic Equipment (WEEE) storage and treatment and End of Life Vehicles (ELVs) to their existing scrap metal and furnace ready scrap metal permit. The activities will include the following for WEEE, manual dismantling and storage in accordance with the WEEE Directive, and the following for ELV treatment, Vehicle depollution and dismantling. All treatment of WEEE and ELV shall take place on impermeable surface with sealed drainage.

These shall be no point source emission into surface waters or groundwater. However, under the emissions of substances not controlled by emission limits rule, clean surface water from roofs, or from areas of the site that are not being used in connection with storing and treating waste, may be discharged directly to surface waters, or to groundwater by seepage through the soil via a soak away.

The status log of the permit sets out the permitting history, including any changes to the permit reference number.

Status log of the permit

Description	Date	Comments
Licensed Issued: Waste disposal License Number: 61578	30/01/1992	Issued by Cheshire County Council.
Modification	07/12/1995	Conditions updated.
Modification	19/04/2000	Name of licence holder changed from Tanhouse MRC Limited to Karalius Brothers (Waste) Limited
Application EPR/DP3296CF/V003 (variation and consolidation)	Duly made 25/11/2013	Application to add vehicle storage, depollution and dismantling (authorised treatment) facility / waste electrical and electronic equipment authorised treatment facility excluding ozone-depleting substances to an existing metal recycling /storage of furnace ready scrap site.
Permit determined EPR/DP3296CF	29/01/2014	Variation and consolidated permit issued in modern template format to Karalius Brothers (Waste) Limited.

End of introductory note

Notice of variation and consolidation

The Environmental Permitting (England and Wales) Regulations 2010

The Environment Agency in exercise of its powers under regulation 20 of the Environmental Permitting (England and Wales) Regulations 2010 varies and consolidates

permit number
EPR/DP3296CF

issued to
Karalius Brothers Waste Limited (“the operator”),

whose registered office is

**Oakley House
Dennis Road
Widnes
Cheshire
United Kingdom
WA8 0YQ**

company registration number **02620363**

to operate waste operations at

**Karalius Brothers (Waste) Limited
Dennis Road
Widnes
Cheshire
WA8 0YQ**

to the extent set out in the schedules.

The notice shall take effect from 29/01/2014

Name	Date
Katie Harwood	29/01/2014

Authorised on behalf of the Environment Agency

Schedule 1

All conditions have been varied by the consolidated permit as a result of the application made by the operator.

Schedule 2 – consolidated permit

Consolidated permit issued as a separate document.

Permit

The Environmental Permitting (England and Wales) Regulations 2010

Permit number
EPR/DP3296CF

The Environment Agency hereby authorises, under regulation 13 of the Environmental Permitting (England and Wales) Regulations 2010

Karalius Brothers Waste Limited (“the operator”),
whose registered office is

**Oakley House
Dennis Road
Widnes
Cheshire
United Kingdom
WA8 0YQ**

company registration number **02620363**

to operate waste operations at

**Karalius Brothers (Waste) Limited
Dennis Road
Widnes
Cheshire
WA8 0YQ**

to the extent authorised by and subject to the conditions of this permit.

Name	Date
Katie Harwood	29/01/2014

Authorised on behalf of the Environment Agency

Conditions

1 Management

General management

- 1.1.1 The operator shall manage and operate the activities:
- (a) in accordance with a written management system that identifies and minimises risks of pollution, including those arising from operations, maintenance, accidents, incidents, non-conformances, closures and those drawn to the attention of the operator as a result of complaints; and
 - (b) using sufficient competent persons and resources.
- 1.1.2 Records demonstrating compliance with condition 1.1.1 shall be maintained.
- 1.1.3 Any person having duties that are or may be affected by the matters set out in this permit shall have convenient access to a copy of it kept at or near the place where those duties are carried out.
- 1.1.4 The operator shall comply with the requirements of an approved competence scheme.

Avoidance, recovery and disposal of wastes produced by the activities

- 1.2.1 The operator shall take appropriate measures to ensure that:
- (a) the waste hierarchy referred to in Article 4 of the Waste Framework Directive is applied to the generation of waste by the activities; and
 - (b) any waste generated by the activities is treated in accordance with the waste hierarchy referred to in Article 4 of the Waste Framework Directive; and
 - (c) where disposal is necessary, this is undertaken in a manner which minimises its impact on the environment.
- 1.2.2 The operator shall review and record at least every four years whether changes to those measures should be made and take any further appropriate measures identified by a review.

2 Operations

2.1 Permitted activities

- 2.1.1 The operator is only authorised to carry out the activities specified in schedule 1 table S1.1 (the "activities").

2.2 The site

- 2.2.1 The activities shall not extend beyond the site, being the land shown edged in green on the site plan at schedule 7 to this permit.

2.3 Operating techniques

- 2.3.1 (a) The activities shall, subject to the conditions of this permit, be operated using the techniques and in the manner described in the documentation specified in schedule 1, table S1.2, unless otherwise agreed in writing by the Environment Agency.
- (b) If notified by the Environment Agency that the activities are giving rise to pollution, the operator shall submit to the Environment Agency for approval within the period specified, a revision of any plan or other documentation ("plan") specified in schedule 1, table S1.2 or otherwise required under this permit which identifies and minimises the risks of pollution relevant to that plan, and shall implement the approved revised plan in place of the original from the date of approval, unless otherwise agreed in writing by the Environment Agency.
- 2.3.2 Waste shall only be accepted if:
- (a) it is of a type and quantity listed in schedule 2 tables S2.1, S2.2, S2.3, S2.4; and
- (b) it conforms to the description in the documentation supplied by the producer and holder.

2.6 Technical requirements

Vehicle depollution and dismantling

- 2.6.1 The storage (including temporary storage) and treatment of waste motor vehicles shall meet the requirements of article 6(1) of the End-of-Life Vehicles Directive.

WEEE treatment

- 2.6.2 The storage (including temporary storage) and treatment of WEEE shall be carried out in accordance with the technical requirements of Annex VIII of the WEEE Directive.
- 2.6.3 WEEE shall be treated using best available treatment, recovery and recycling techniques (BATRRRT).
- 2.6.4 As a minimum, the substances, preparations and components specified in table 2.6 shall be removed from any separately collected WEEE.

Table 2.6 Substances, preparations and components to be removed from separately collected WEEE

- Capacitors containing Polychlorinated biphenyls (PCB)
- Mercury-containing components, such as switches or backlighting lamps
- Batteries
- Printed circuit boards of mobile phones generally, and of other devices if the surface of the printed circuit board is greater than 10 square centimetres
- Toner cartridges, liquid and pasty, as well as colour toner
- Plastic containing brominated flame retardants
- Asbestos waste and components which contain asbestos
- Cathode ray tubes
- Chlorofluorocarbons (CFC), hydrochlorofluorocarbons (HCFC), hydrofluorocarbons (HFC), or hydrocarbons (HC)
- Gas discharge lamps
- Liquid crystal displays (together with their casing where appropriate) of a surface greater than 100 square centimetres and all those back-lighted with gas discharge lamps
- External electric cables
- Components containing refractory ceramic fibres
- Components containing radioactive substances with the exception of components that are below the exemption thresholds set in Article 3 of and the Annex I to Council Directive 96/29/Euratom of 13 May 1996 laying down basic safety standards for the protection of the health of workers and the general public against the dangers arising from ionising radiation
- Electrolytic capacitors containing “substances of concern” (height > 25mm, diameter > 25 mm or proportionately similar volume)

2.6.5 All fluids contained within any WEEE shall be removed prior to further treatment.

2.6.6 Separately collected components of WEEE specified in table 2.7 shall be treated in accordance with the methods specified in that table.

Table 2.7 Specified Treatment Methods for separately collected components of WEEE

Component	Specified Treatment
Cathode ray tubes	The fluorescent coating shall be removed.
Gas discharge lamps	The mercury shall be removed.

2.6.7 Equipment shall be provided to record the weight of untreated WEEE accepted at, and components and materials leaving the site.

Hazardous waste storage and treatment

2.6.8 Hazardous waste shall not be mixed, either with a different category of hazardous waste or with other waste, substances or materials, unless it is authorised by schedule 1 table S1.1 and appropriate measures are taken.

3 Emissions and monitoring

3.1 Emissions to water, air or land

3.1.1 There shall be no point source emissions to water, air or land.

3.2 Emissions of substances not controlled by emission limits

3.2.1 Emissions of substances not controlled by emission limits (excluding odour) shall not cause pollution. The operator shall not be taken to have breached this condition if appropriate measures, including, but not limited to, those specified in any approved emissions management plan, have been taken to prevent or where that is not practicable, to minimise, those emissions.

3.2.2 The operator shall:

- (a) if notified by the Environment Agency that the activities are giving rise to pollution, submit to the Environment Agency for approval within the period specified, an emissions management plan which identifies and minimises the risks of pollution from emissions of substances not controlled by emission limits;
- (b) implement the approved emissions management plan, from the date of approval, unless otherwise agreed in writing by the Environment Agency.

3.2.3 All liquids in containers, whose emission to water or land could cause pollution, shall be provided with secondary containment, unless the operator has used other appropriate measures to prevent or where that is not practicable, to minimise, leakage and spillage from the primary container.

3.3 Odour

3.3.1 Emissions from the activities shall be free from odour at levels likely to cause pollution outside the site, as perceived by an authorised officer of the Environment Agency, unless the operator has used appropriate measures, including, but not limited to, those specified in any approved odour management plan, to prevent or where that is not practicable to minimise the odour.

3.3.2 The operator shall:

- (a) if notified by the Environment Agency that the activities are giving rise to pollution outside the site due to odour, submit to the Environment Agency for approval within the period specified, an odour management plan which identifies and minimises the risks of pollution from odour;
- (b) implement the approved odour management plan, from the date of approval, unless otherwise agreed in writing by the Environment Agency.

3.4 Noise and vibration

3.4.1 Emissions from the activities shall be free from noise and vibration at levels likely to cause pollution outside the site, as perceived by an authorised officer of the Environment Agency, unless the operator has used appropriate measures, including, but not limited to, those specified in any approved noise and vibration management plan to prevent or where that is not practicable to minimise the noise and vibration.

- 3.4.2 The operator shall:
- (a) if notified by the Environment Agency that the activities are giving rise to pollution outside the site due to noise and vibration, submit to the Environment Agency for approval within the period specified, a noise and vibration management plan which identifies and minimises the risks of pollution from noise and vibration;
 - (b) implement the approved noise and vibration management plan, from the date of approval, unless otherwise agreed in writing by the Environment Agency.

4 Information

4.1 Records

- 4.1.1 All records required to be made by this permit shall:
- (a) be legible;
 - (b) be made as soon as reasonably practicable;
 - (c) if amended, be amended in such a way that the original and any subsequent amendments remain legible, or are capable of retrieval; and
 - (d) be retained, unless otherwise agreed in writing by the Environment Agency, for at least 6 years from the date when the records were made, or in the case of the following records until permit surrender:
 - (i) off-site environmental effects; and
 - (ii) matters which affect the condition of the land and groundwater.
- 4.1.2 The operator shall keep on site all records, plans and the management system required to be maintained by this permit, unless otherwise agreed in writing by the Environment Agency.

4.2 Reporting

- 4.2.1 The operator shall send all reports and notifications required by the permit to the Environment Agency using the contact details supplied in writing by the Environment Agency.
- 4.2.2 Within one month of the end of each year, the operator shall submit to the Environment Agency using the form made available for the purpose, the information specified on the form relating to the site and the waste accepted and removed from it during the previous year.

4.3 Notifications

- 4.3.1 The Environment Agency shall be notified without delay following the detection of:
- (a) any malfunction, breakdown or failure of equipment or techniques, accident, or emission of a substance not controlled by an emission limit which has caused, is causing or may cause significant pollution;

- (b) the breach of a limit specified in the permit; or
 - (c) any significant adverse environmental effects.
- 4.3.2 Any information provided under condition 4.3.1 shall be confirmed by sending the information listed in schedule 5 to this permit within the time period specified in that schedule.
- 4.3.3 Where the Environment Agency has requested in writing that it shall be notified when the operator is to undertake monitoring and/or spot sampling, the operator shall inform the Environment Agency when the relevant monitoring and/or spot sampling is to take place. The operator shall provide this information to the Environment Agency at least 14 days before the date the monitoring is to be undertaken.
- 4.3.4 The Environment Agency shall be notified within 14 days of the occurrence of the following matters, except where such disclosure is prohibited by Stock Exchange rules:
- Where the operator is a registered company:
- (a) any change in the operator's trading name, registered name or registered office address; and
 - (b) any steps taken with a view to the operator going into administration, entering into a company voluntary arrangement or being wound up.
- Where the operator is a corporate body other than a registered company:
- (a) any change in the operator's name or address; and
 - (b) any steps taken with a view to the dissolution of the operator.
- In any other case:
- (a) the death of any of the named operators (where the operator consists of more than one named individual);
 - (b) any change in the operator's name(s) or address(es); and
 - (c) any steps taken with a view to the operator, or any one of them, going into bankruptcy, entering into a composition or arrangement with creditors, or, in the case of them being in a partnership, dissolving the partnership.
- 4.3.5 Where the operator proposes to make a change in the nature or functioning, or an extension of the activities, which may have consequences for the environment and the change is not otherwise the subject of an application for approval under the Regulations or this permit:
- (a) the Environment Agency shall be notified at least 14 days before making the change; and
 - (b) the notification shall contain a description of the proposed change in operation.

4.4 Interpretation

- 4.4.1 In this permit the expressions listed in schedule 6 shall have the meaning given in that schedule.
- 4.4.2 In this permit references to reports and notifications mean written reports and notifications, except where reference is made to notification being made "without delay", in which case it may be provided by telephone.

Schedule 1 - Operations

Table S1.1 activities		
Activity Reference	Description of activities for waste operations	Limits of activities and waste types
A1 Vehicle storage, depollution and dismantling (authorised treatment) facility.	R13: Storage of waste pending any of the operations numbered R1 to R12 (excluding temporary storage, pending collection, on the site where it is produced)	<p>Treatment operations shall be limited to:</p> <p>Except for treatment in shredders, treatment consisting only of depollution of waste motor vehicles and sorting, separation, grading, baling, shearing, compacting, crushing or cutting of waste into different components for recovery of wastes.</p> <p>Treatment in shredders of ELVs and their components for disposal (50 tonnes per day) or recovery (75 tonnes per day).</p>
	D15: Storage pending any of the operations numbered D 1 to D 14 (excluding temporary storage, pending collection, on the site where the waste is produced)	<p>Physical treatment including manual and mechanical sorting/ separation, screening, crushing, baling of non-hazardous waste for disposal (no more than 50 tonnes per day) or recovery.</p> <p>The maximum quantity of hazardous waste and waste oils (in aggregate) that can be accepted at the site shall not exceed 50 tonnes per day.</p>
	R4: Recycling/ reclamation of metals and metal compounds	<p>The maximum quantity of hazardous waste and waste oils (in aggregate) that can be stored at the site shall not exceed 80 tonnes.</p>
	R5: Recycling/ reclamation of other inorganic compounds	<p>Wastes shall be stored for no longer than 1 year prior to disposal and 3 years prior to recovery.</p> <p>No more than 25 tonnes of intact waste vehicle tyres (waste code 16 01 03) shall be stored at the site.</p>
		<p>Buildings, covered areas or containers shall meet the following requirements:</p> <ul style="list-style-type: none"> • buildings, covered areas, or containers shall be designed, constructed and maintained to prevent ingress of rain and surface water; • rain and uncontaminated surface water shall be kept separate from contaminated water and other liquids; • containers shall be stored on an impermeable surface with sealed drainage system. <p>All wastes shall be treated on an impermeable surface with sealed drainage system.</p> <p>Uncontaminated plastic, glass and ferrous and non- ferrous metal wastes arising from the treatment of end-of-life vehicles shall be stored on hard standing or an impermeable surface with sealed drainage system. All other wastes shall be stored on an impermeable surface with sealed drainage system.</p> <p>Lead acid batteries shall be stored in containers with an impermeable, acid resistant base and a lid to prevent ingress of water.</p>
Waste types as specified in Table S2.1		

Table S1.1 activities

Activity Reference	Description of activities for waste operations	Limits of activities and waste types
A2 Waste electrical and electronic equipment authorised treatment facility excluding ozone-depleting substances	<p>R13: Storage of waste pending any of the operations numbered R1 to R12 (excluding temporary storage, pending collection, on the site where it is produced)</p> <p>D15: Storage pending any of the operations numbered D 1 to D 14 (excluding temporary storage, pending collection, on the site where the waste is produced)</p> <p>R4: Recycling/ reclamation of metals and metal compounds</p> <p>R5: Recycling/ reclamation of other inorganic compounds</p> <p>D14: Repackaging prior to submission to any of the operations numbered D1 to D13</p>	<p>Treatment operations shall be limited to:</p> <p>Except for treatment in shredders, treatment consisting only of sorting, dismantling, separation, shredding, screening, grading, baling, shearing, compacting, crushing, granulation, repair or refurbishment, or cutting of waste into different components for recovery.</p> <p>Treatment in shredders of WEEE and their components for disposal (50 tonnes per day) or recovery (75 tonnes per day).</p> <p>Physical treatment including manual and mechanical sorting/ separation, screening, crushing, baling of non-hazardous waste for disposal (no more than 50 tonnes per day) or recovery.</p> <p>The maximum quantity of hazardous waste and waste oils (in aggregate) that can be accepted at the site shall not exceed 50 tonnes per day.</p> <p>The maximum quantity of hazardous waste and waste oils (in aggregate) that can be stored at the site shall not exceed 80 tonnes.</p> <p>Wastes shall be stored for no longer than 1 year prior to disposal or 3 years prior to recovery.</p> <p>There will be no treatment of waste fridges. Waste fridges will only be stored on site.</p> <p>Buildings, covered areas or containers shall meet the following requirements:</p> <ul style="list-style-type: none"> ● buildings, covered areas, or containers shall be designed, constructed and maintained to prevent ingress of rain and surface water; ● rain and uncontaminated surface water shall be kept separate from contaminated water and other liquids; ● containers shall be stored on an impermeable surface with sealed drainage system. <p>Treatment of WEEE:</p> <ul style="list-style-type: none"> ● shall be carried out within a building provided with a weatherproof covering; ● shall be carried out on an impermeable surface with sealed drainage system with provision of spillage collection facilities and, where appropriate, decanters and cleanser degreasers. <p>Storage:</p> <ul style="list-style-type: none"> ● WEEE, disassembled spare parts, components or residues shall be stored on an impermeable surface with sealed drainage system with provision of spillage collection facilities and, where appropriate, decanters and cleanser degreasers; ● WEEE, disassembled spare parts, components or residues shall be stored in areas provided with a weatherproof covering where appropriate or in containers providing a weatherproof covering where appropriate;

Table S1.1 activities

Activity Reference	Description of activities for waste operations	Limits of activities and waste types
		<ul style="list-style-type: none"> ● Disassembled spare parts containing liquids shall be stored in appropriate containers; ● Batteries, PCBs/PCTs containing capacitors and other hazardous wastes must be stored in dedicated, labelled and appropriate containers <p>Waste types as specified in Table S2.2</p>
A3 Metal Recycling	<p>R13: Storage of waste pending any of the operations numbered R1 to R12 (excluding temporary storage, pending collection, on the site where it is produced)</p> <p>R4: Recycling/ reclamation of metals and metal compounds</p>	<p>Treatment operations shall be limited to:</p> <p>Except for treatment in shredders of metal waste, treatment consisting only of manual sorting, separation, shredding, compaction, shearing or cutting of non hazardous waste into different components for recovery.</p> <p>Treatment in shredders of metal waste, including WEEE and ELVs and their components for disposal (50 tonnes per day) or recovery (75 tonnes per day)</p> <p>Physical treatment including manual and mechanical sorting/ separation, screening, crushing, baling of non-hazardous waste for disposal (no more than 50 tonnes per day) or recovery.</p> <p>The maximum quantity of hazardous waste and waste oils (in aggregate) that can be accepted at the site shall not exceed 50 tonnes per day.</p> <p>The maximum quantity of hazardous waste and waste oils (in aggregate) that can be stored at the site shall not exceed 80 tonnes.</p> <p>There shall be no treatment of lead acid batteries, other than sorting and separating from other wastes.</p> <p>Wastes shall be stored for no longer than 3 years prior to recovery.</p> <p>Buildings, covered areas or containers shall meet the following requirements:</p> <ul style="list-style-type: none"> ● buildings, covered areas, or containers shall be designed, constructed and maintained to prevent ingress of rain and surface water; ● rain and uncontaminated surface water shall be kept separate from contaminated water and other liquids; ● containers shall be stored on an impermeable surface with sealed drainage system. <p>Uncontaminated ferrous metal wastes or alloys and uncontaminated non-ferrous metal wastes shall be stored on hard standing or an impermeable surface. All other wastes shall be stored on an impermeable surface with sealed drainage system.</p> <p>All wastes shall be treated on an impermeable surface with sealed drainage system.</p> <p>Lead acid batteries shall be stored in containers with an impermeable, acid resistant base and a cover to prevent ingress of water.</p>

Table S1.1 activities

Activity Reference	Description of activities for waste operations	Limits of activities and waste types
		Metal filings and turnings shall be stored in containers with an impermeable base and a cover to prevent the ingress of water. No more than 50 tonnes shall be stored at any one time
		Waste types as specified in Table S2.3
A4 Storage of Furnace Ready Scrap	R13: Storage of waste pending any of the operations numbered R1 to R12 (excluding temporary storage, pending collection, on the site where it is produced)	Wastes shall be stored for no longer than 3 years prior to recovery. Uncontaminated furnace ready scrap metal waste shall be stored on hard standing or an impermeable surface. All other furnace ready scrap metal waste shall be stored on an impermeable surface with sealed drainage system. Waste types as specified in Table S2.4

Table S1.2 Operating techniques

Description	Parts	Date Received
Application	Table 3a of application form C4 as part of the application. Application form C2 and supporting documents.	17/09/2013
Email, from Peter Hill on 16/01/2014 10:35	Confirmation of understanding of responsibilities as a Hazardous Waste Producer.	16/01/2014

Schedule 2 - Waste types

Table S2.1 Permitted waste types and quantities for Vehicle storage, depollution and dismantling (authorised treatment) facility.

Maximum Quantities

The total quantity of waste accepted at the site shall not exceed 74,999 tonnes per year.

The total ELV waste to be treated shall not exceed 5,000 tonnes per year.

Exclusions

Wastes having any of the following characteristics shall not be accepted:

- Consisting solely or mainly of dusts, powders or loose fibres

Waste code	Description
16	WASTES NOT OTHERWISE SPECIFIED IN THE LIST
16 01	end-of-life vehicles from different means of transport (including off-road machinery) and wastes from dismantling of end-of-life vehicles and vehicle maintenance (except 13, 14, 16 06 and 16 08)
16 01 03	end of life tyres
16 01 04*	end-of-life vehicles
16 01 06	end-of life vehicles (containing neither liquids nor other hazardous components)
16 01 07*	oil filters
16 01 11*	brake pads containing asbestos
16 01 12	brake pads other than those mentioned in 16 01 11
16	WASTES NOT OTHERWISE SPECIFIED IN THE LIST
16 01	end-of-life vehicles from different means of transport (including off-road machinery) and wastes from dismantling of end-of-life vehicles and vehicle maintenance (except 13, 14, 16 06 and 16 08)
16 01 16	tanks for liquefied gas
16 01 17	ferrous metal
16 0118	non-ferrous metal
16 01 19	plastic
16 01 20	glass
16 01 21*	hazardous components other than those mentioned in 16 01 07 to 16 01 11 and 16 01 13 and 16 01 14
16 01 22	components not otherwise specified
16 06	batteries and accumulators
16 06 01*	lead batteries
16 06 05	other batteries and accumulators

Table S2.2 Permitted Waste types and quantities for Waste Electrical and Electronic Equipment authorised treatment facility excluding ozone-depleting substances

Maximum Quantities

The total quantity of waste accepted at the site shall not exceed 74,999 tonnes per year.

The total WEEE waste to be treated shall not exceed 4,999 tonnes per year.

Exclusions

Wastes having any of the following characteristics shall not be accepted:

- Consisting solely or mainly of dusts, powders or loose fibres

Waste Code	Description
09	WASTES FROM THE PHOTOGRAPHIC INDUSTRY
09 01	wastes from the photographic industry

Table S2.2 Permitted Waste types and quantities for Waste Electrical and Electronic Equipment authorised treatment facility excluding ozone-depleting substances

Maximum Quantities

The total quantity of waste accepted at the site shall not exceed 74,999 tonnes per year.

The total WEEE waste to be treated shall not exceed 4,999 tonnes per year.

Exclusions

Wastes having any of the following characteristics shall not be accepted:

- Consisting solely or mainly of dusts, powders or loose fibres

Waste Code	Description
09 01 11*	single-use cameras containing batteries included in 16 06 01, 16 06 02 or 16 06 03
09 01 12	single-use cameras containing batteries other than those mentioned in 09 01 11
15	WASTE PACKAGING; ABSORBENTS, WIPING CLOTHS, FILTER MATERIALS AND PROTECTIVE CLOTHING NOT OTHERWISE SPECIFIED
15 01	packaging (including separately collected municipal packaging waste)
15 01 06	mixed packaging
16	WASTES NOT OTHERWISE SPECIFIED IN THE LIST
16 02	wastes from electrical and electronic equipment
16 02 09*	transformers and capacitors containing PCBs
16 02 10*	discarded equipment containing or contaminated by PCBs other than those mentioned in 16 02 09
16 02 11*	discarded equipment containing chlorofluorocarbons, HCFC, HFC
16 02 12*	discarded equipment containing free asbestos
16 02 13*	discarded equipment containing hazardous components other than those mentioned in 16 02 09 to 16 02 12
16 02 14	discarded equipment other than those mentioned in 16 02 09 to 16 02 13
16 02 15*	hazardous components removed from discarded equipment
16 02 16	components removed from discarded equipment other than those mentioned in 16 02 15
16 06	batteries and accumulators
16 06 01*	lead batteries
16 06 02*	Ni-Cd batteries
16 06 03*	mercury-containing batteries
16 06 04	alkaline batteries (except 16 06 03)
16 06 05	other batteries and accumulators
20	MUNICIPAL WASTES (HOUSEHOLD WASTE AND SIMILAR COMMERCIAL, INDUSTRIAL AND INSTITUTIONAL WASTES) INCLUDING SEPARATELY COLLECTED FRACTIONS
20 01	separately collected fractions (except 15 01)
20 01 21*	fluorescent tubes and other mercury-containing waste
20 01 23*	discarded equipment containing chlorofluorocarbons
20 01 33*	batteries and accumulators included in 16 06 01, 16 06 02 or 16 06 03 and unsorted batteries and accumulators containing these batteries
20 01 34	batteries and accumulators other than those mentioned in 20 01 33
20 01 35*	discarded electrical and electronic equipment other than those mentioned in 20 01 21 and 20 01 23 containing hazardous components
20 01 36	discarded electrical and electronic equipment other than those mentioned in 20 01 21, 20 01 23 and 20 01 35

Table S2.3 Permitted Waste types and quantities for Metal Recycling**Maximum Quantities**

The total quantity of waste accepted at the site shall not exceed 74,999 tonnes per year.

Exclusions

Wastes having any of the following characteristics shall not be accepted:

- Consisting solely or mainly of dusts, powders or loose fibres
- Wastes that are in a form which is either sludge or liquid

Waste Code	Description
02	WASTES FROM AGRICULTURE, HORTICULTURE, AQUACULTURE, FORESTRY, HUNTING AND FISHING, FOOD PREPARATION AND PROCESSING
02 01	wastes from agriculture, horticulture, aquaculture, forestry, hunting and fishing
02 01 10	waste metal
12	WASTES FROM SHAPING AND PHYSICAL AND MECHANICAL SURFACE TREATMENT OF METALS AND PLASTICS
12 01	wastes from shaping and physical and mechanical surface treatment of metals and plastics
12 01 01	ferrous metal filings and turnings
12 01 03	non-ferrous metal filings and turnings
15	WASTE PACKAGING; ABSORBENTS, WIPING CLOTHS, FILTER MATERIALS AND PROTECTIVE CLOTHING NOT OTHERWISE SPECIFIED
15 01	packaging (including separately collected municipal packaging waste)
15 01 04	metallic packaging
16	WASTES NOT OTHERWISE SPECIFIED IN THE LIST
16 01	end-of-life vehicles from different means of transport (including off-road machinery) and waste from dismantling of end-of-life vehicles and vehicle maintenance (except 13, 14, 16 06 and 16 08)
16 01 06	end-of-life vehicles containing neither liquids nor other hazardous components
16 01 17	ferrous metal
16 01 18	non-ferrous metal
16 01 22	components not otherwise specified
16 06	batteries and accumulators
16 06 01*	lead batteries
17	CONSTRUCTION AND DEMOLITION WASTES (INCLUDING EXCAVATED SOIL FROM CONTAMINATED SITES)
17 04	metals (including their alloys)
17 04 01	copper, bronze, brass
17 04 02	aluminium
17 04 03	lead
17 04 04	zinc
17 04 05	iron and steel
17 04 06	tin
17 04 07	mixed metals
17 04 11	cables other than those mentioned in 17 04 10
19	WASTES FROM WASTE MANAGEMENT FACILITIES, OFF-SITE WASTE WATER TREATMENT PLANTS AND THE PREPARATION OF WATER INTENDED FOR HUMAN CONSUMPTION AND WATER FOR INDUSTRIAL USE
19 01	wastes from incineration or pyrolysis of waste
19 01 02	ferrous materials removed from bottom ash
19 10	wastes from shredding of metal-containing wastes
19 10 01	iron and steel waste

Table S2.3 Permitted Waste types and quantities for Metal Recycling**Maximum Quantities**

The total quantity of waste accepted at the site shall not exceed 74,999 tonnes per year.

Exclusions

Wastes having any of the following characteristics shall not be accepted:

- Consisting solely or mainly of dusts, powders or loose fibres
- Wastes that are in a form which is either sludge or liquid

Waste Code	Description
19 10 02	non-ferrous wastes
19 12	wastes from the mechanical treatment of waste (for example sorting, crushing, compacting, pelletising) not otherwise specified
19 12 02	ferrous metal
19 12 03	non-ferrous metal
20	MUNICIPAL WASTES (HOUSEHOLD WASTE AND SIMILAR COMMERCIAL, INDUSTRIAL AND INSTITUTIONAL WASTES) INCLUDING SEPARATELY COLLECTED FRACTIONS
20 01	separately collected fractions (except 15 01)
20 01 33*	batteries and accumulators included in 16 06 01, 16 06 02 or 16 06 03 and unsorted batteries and accumulators containing these batteries
20 01 40	metals

Table S2.4 Permitted Waste types and quantities for Furnace Ready Scrap Storage**Maximum Quantities**

The total quantity of waste accepted at the site shall not exceed 74,999 tonnes per year.

Exclusions

Wastes having any of the following characteristics shall not be accepted:

- Consisting solely or mainly of dusts, powders or loose fibres
- Wastes that are in a form which is either sludge or liquid

Waste Code	Description
02	WASTES FROM AGRICULTURE, HORTICULTURE, AQUACULTURE, FORESTRY, HUNTING AND FISHING, FOOD PREPARATION AND PROCESSING
02 01	wastes from agriculture, horticulture, aquaculture, forestry, hunting and fishing
02 01 10	waste metal
12	WASTES FROM SHAPING AND PHYSICAL AND MECHANICAL SURFACE TREATMENT OF METALS AND PLASTICS
12 01	wastes from shaping and physical and mechanical surface treatment of metals and plastics
12 01 01	ferrous metal filings and turnings
12 01 03	non-ferrous metal filings and turnings
15	WASTE PACKAGING; ABSORBENTS, WIPING CLOTHS, FILTER MATERIALS AND PROTECTIVE CLOTHING NOT OTHERWISE SPECIFIED
15 01	packaging (including separately collected municipal packaging waste)
15 01 04	metallic packaging
16	WASTES NOT OTHERWISE SPECIFIED IN THE LIST
16 01	end-of-life vehicles from different means of transport (including off-road machinery) and waste from dismantling of end-of-life vehicles and vehicle maintenance (except 13, 14, 16 06 and 16 08)
16 01 17	ferrous metal
16 01 18	non-ferrous metal

Table S2.4 Permitted Waste types and quantities for Furnace Ready Scrap Storage**Maximum Quantities**

The total quantity of waste accepted at the site shall not exceed 74,999 tonnes per year.

Exclusions

Wastes having any of the following characteristics shall not be accepted:

- Consisting solely or mainly of dusts, powders or loose fibres
- Wastes that are in a form which is either sludge or liquid

Waste Code	Description
16 01 22	components not otherwise specified
16 02	discarded equipment and its components
16 02 14	discarded equipment other than those mentioned in 16 02 09 to 16 02 13 (ferrous and non-ferrous metal waste only)
16 02 16	components removed from discarded equipment other than those mentioned in 16 02 15 (ferrous and non-ferrous metal waste only)
16 06	batteries and accumulators
16 06 01*	lead batteries
17	CONSTRUCTION AND DEMOLITION WASTES (INCLUDING EXCAVATED SOIL FROM CONTAMINATED SITES)
17 04	metals (including their alloys)
17 04 01	copper, bronze, brass
17 04 02	aluminium
17 04 03	lead
17 04 04	zinc
17 04 05	iron and steel
17 04 06	tin
17 04 07	mixed metals
17 04 11	cables other than those mentioned in 17 04 10
19	WASTES FROM WASTE MANAGEMENT FACILITIES, OFF-SITE WASTE WATER TREATMENT PLANTS AND THE PREPARATION OF WATER INTENDED FOR HUMAN CONSUMPTION AND WATER FOR INDUSTRIAL USE
19 01	wastes from incineration or pyrolysis of waste
19 01 02	ferrous materials removed from bottom ash
19 10	wastes from shredding of metal-containing wastes
19 10 01	iron and steel waste
19 10 02	non-ferrous wastes
19 12	wastes from the mechanical treatment of waste (for example sorting, crushing, compacting, pelletising) not otherwise specified
19 12 02	ferrous metal
19 12 03	non-ferrous metal
20	MUNICIPAL WASTES (HOUSEHOLD WASTE AND SIMILAR COMMERCIAL, INDUSTRIAL AND INSTITUTIONAL WASTES) INCLUDING SEPARATELY COLLECTED FRACTIONS
20 01	separately collected fractions (except 15 01)
20 01 40	metals

Schedule 3 – Emissions and monitoring

There are no emission limits or associated emission monitoring requirements.

Schedule 4 - Reporting

There is no reporting under this schedule.

Schedule 5 - Notification

These pages outline the information that the operator must provide.

Units of measurement used in information supplied under Part A and B requirements shall be appropriate to the circumstances of the emission. Where appropriate, a comparison should be made of actual emissions and authorised emission limits.

If any information is considered commercially confidential, it should be separated from non-confidential information, supplied on a separate sheet and accompanied by an application for commercial confidentiality under the provisions of the EP Regulations.

Part A

Permit Number	
Name of operator	
Location of Facility	
Time and date of the detection	

(a) Notification requirements for any malfunction, breakdown or failure of equipment or techniques, accident, or emission of a substance not controlled by an emission limit which has caused, is causing or may cause significant pollution

To be notified within 24 hours of detection
--

Date and time of the event	
Reference or description of the location of the event	
Description of where any release into the environment took place	
Substances(s) potentially released	
Best estimate of the quantity or rate of release of substances	
Measures taken, or intended to be taken, to stop any emission	
Description of the failure or accident.	

(b) Notification requirements for the breach of a limit
--

To be notified within 24 hours of detection unless otherwise specified below

Emission point reference/ source	
Parameter(s)	
Limit	
Measured value and uncertainty	
Date and time of monitoring	
Measures taken, or intended to be taken, to stop the emission	

Time periods for notification following detection of a breach of a limit	
Parameter	Notification period

(c) Notification requirements for the detection of any significant adverse environmental effect	
To be notified within 24 hours of detection	
Description of where the effect on the environment was detected	
Substances(s) detected	
Concentrations of substances detected	
Date of monitoring/sampling	

Part B - to be submitted as soon as practicable

Any more accurate information on the matters for notification under Part A.	
Measures taken, or intended to be taken, to prevent a recurrence of the incident	
Measures taken, or intended to be taken, to rectify, limit or prevent any pollution of the environment which has been or may be caused by the emission	
The dates of any unauthorised emissions from the facility in the preceding 24 months.	

Name*	
Post	
Signature	
Date	

* authorised to sign on behalf of the operator

Schedule 6 - Interpretation

“*accident*” means an accident that may result in pollution.

“*Annex I*” means Annex I to Directive 2008/98/EC of the European Parliament and of the Council on waste.

“*Annex II*” means Annex II to Directive 2008/98/EC of the European Parliament and of the Council on waste.

“*application*” means the application for this permit, together with any additional information supplied by the operator as part of the application and any response to a notice served under Schedule 5 to the EP Regulations.

“*authorised officer*” means any person authorised by the Environment Agency under section 108(1) of The Environment Act 1995 to exercise, in accordance with the terms of any such authorisation, any power specified in section 108(4) of that Act.

“*best available treatment, recovery and recycling techniques*” shall have the meaning given to it in the document published jointly by the Department for Environment, Food and Rural Affairs, the Welsh Assembly Government and the Scottish Executive on 27th November 2006, entitled “Guidance on Best Available Treatment, Recovery and Recycling Techniques (BATRRRT) and Treatment of Waste Electrical and Electronic Equipment (WEEE);

“*building*” means a construction that has the objective of providing sheltering cover and minimising emissions of noise, particulate matter, odour and litter.

“*controlled substances*” means *chlorofluorocarbons, other fully halogenated chlorofluorocarbons, halons, carbon tetrachloride, 1,1,1-trichloroethane, methyl bromide, hydrobromofluorocarbons and hydrochlorofluorocarbons listed in Annex I of Regulation (EC) No 2037/2000 of the European Parliament and of the Council of 29 June 2000 on substances that deplete the ozone layer, including their isomers, whether alone or in a mixture, and whether they are virgin, recovered, recycled or reclaimed. This definition shall not cover any controlled substance which is in a manufactured product other than a container used for the transportation or storage of that substance, or insignificant quantities of any controlled substance, originating from inadvertent or coincidental production during a manufacturing process, from unreacted feedstock, or from use as a processing agent which is present in chemical substances as trace impurities, or that is emitted during product manufacture or handling.*

“*D*” means a disposal operation provided for in Annex I to Directive 2008/98/EC of the European Parliament and of the Council on waste.

“*End-of-Life Vehicles Directive*” means Directive 2000/53/EC of the European Parliament and Council of 18 September 2000 on end-of-life vehicles.

“*emissions to land*” includes emissions to groundwater.

“*EP Regulations*” means The Environmental Permitting (England and Wales) Regulations SI 2010 No.675 and words and expressions used in this permit which are also used in the Regulations have the same meanings as in those Regulations.

“emissions of substances not controlled by emission limits” means emissions of substances to air, water or land from the activities, either from the emission points specified in schedule 3 or from other localised or diffuse sources, which are not controlled by an emission or background concentration limit..

“groundwater” means all water, which is below the surface of the ground in the saturation zone and in direct contact with the ground or subsoil.

“hazardous waste” has the meaning given in the Hazardous Waste (England and Wales) Regulations 2005 No.894, the Hazardous Waste (Wales) Regulations 2005 No. 1806 (W.138), the List of Wastes (England) Regulations 2005 No.895 and the List of Wastes (Wales) Regulations 2005 No. 1820 (W.148).

“MCERTS” means the Environment Agency’s Monitoring Certification Scheme.

“nearest sensitive receptors” means the nearest place to the composting operations where people are likely to be for prolonged or frequent periods. This term would therefore apply to dwellings (including any associated gardens) and to workplaces where workers would frequently be present. It does not apply to the operators of composting facilities or their staff while carrying out the composting operation as their health is covered by Health and Safety legislation.

“ozone-depleting substances” “ODS” means “controlled substances” contained in refrigeration, air-conditioning and heat pump equipment, equipment containing solvents, fire protection systems and fire extinguishers.

“R” means a recovery operation provided for in Annex II to Directive 2008/98/EC of the European Parliament and of the Council on waste.

“Waste code” means the six digit code referable to a type of waste in accordance with the List of Wastes (England) Regulations 2005, or List of Wastes (Wales) Regulations 2005, as appropriate, and in relation to hazardous waste, includes the asterisk.

“Waste Framework Directive” or “WFD” means Waste Framework Directive 2008/98/EC of the European Parliament and of the Council on waste.

“WEEE” means waste electrical and electronic equipment.

“WEEE Directive” means Directive 2002/96/EC of the European Parliament and of the Council of 27th January 2003 on waste electrical and electronic equipment (WEEE) as amended by Directive 2012/19/EU of the European Parliament and of the Council of 8th December 2012 on waste electrical and electronic equipment (WEEE).

“year” means calendar year ending 31 December.

Schedule 7 - Site plan

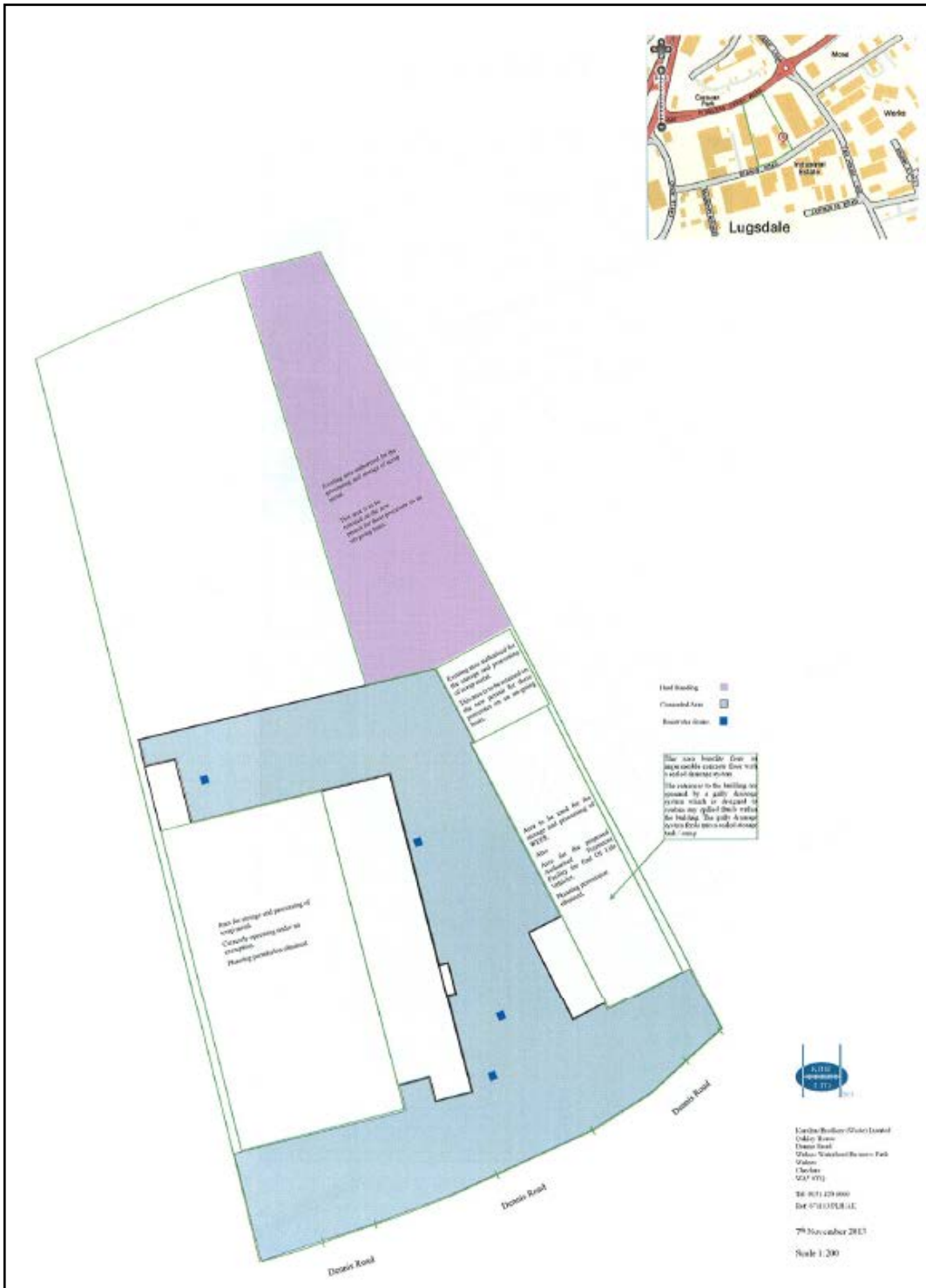

END OF PERMIT